

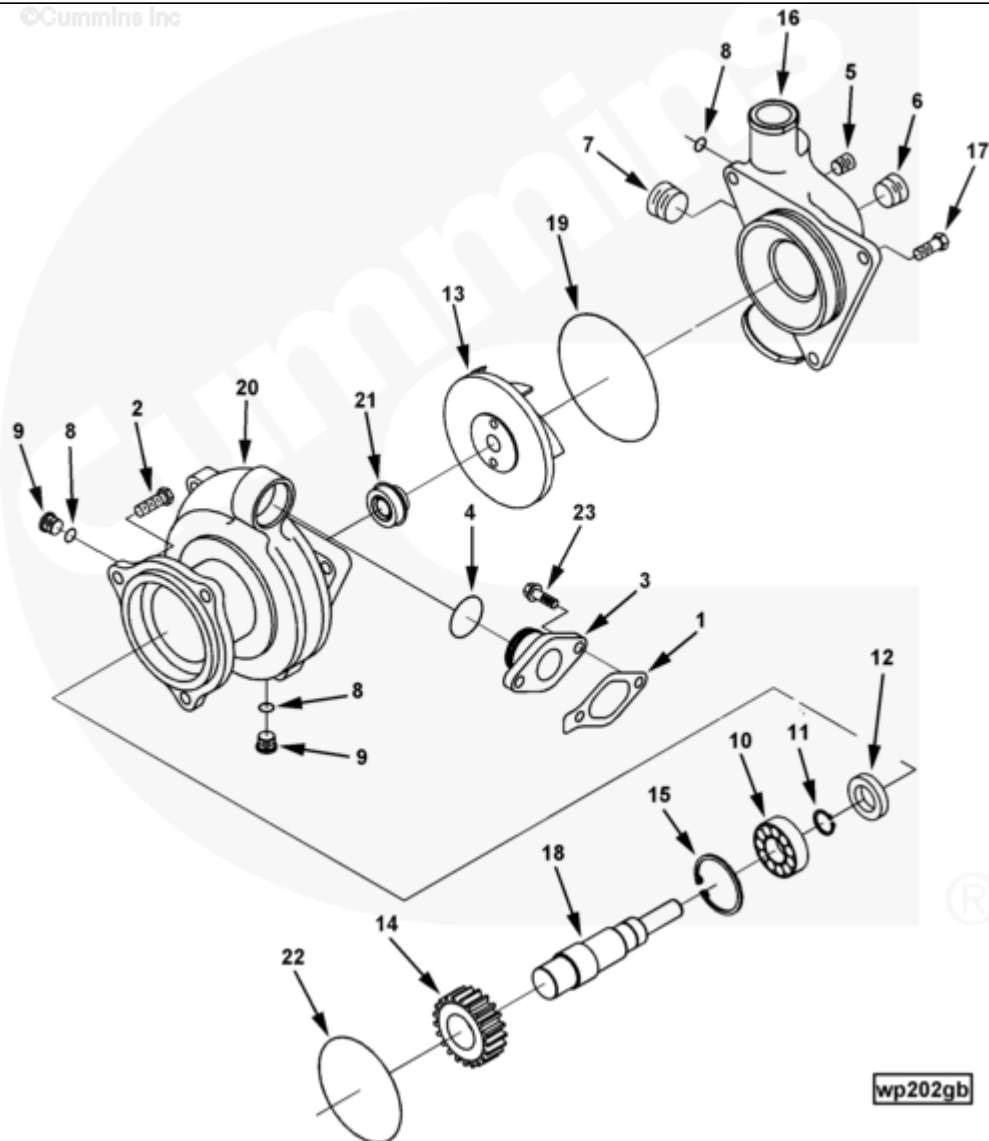

Parts Catalog - Option Detail

Electronic Parts Catalog - Option Detail				
Option	Group	Graphic	Film Card	Date
WP2705-10	08.01	wp202gb	II	07-NOV-11
Engines	ISM CM570, ISM CM570/870, ISM CM875, ISM CM876, ISM CM876 E, ISM11 CM876 SN, M11 CELECT, M11 CELECT PLUS, M11 MECHANICAL, QSM11 CM570, QSM11 CM876			



SMALL | MEDIUM | LARGE

Cart	Ref No	Part Number	Part Description	Required	Remarks
View My Cart					
		WP2705-10	Water Pump		Water Pump...(More)

					Alternator Drive Provision:
					No
					Inlet Connection Type:
					Straight
					Shaft Length (mm): 64.097
					This Water Pump Is Designed
					For Use With The Two-Pass Oil
					Cooler.
<input type="checkbox"/>	1	3027924	Connection Gasket	1	
<input type="checkbox"/>	2	3034836	Hexagon Head Cap Screw	3	M10 X 1.50 X 30.
<input type="checkbox"/>		3328559	Water Transfer Connection	1	
<input type="checkbox"/>	3	3821718	Water Transfer Connection	1	
<input type="checkbox"/>	4	3892095	O-Ring Seal	1	
<input type="checkbox"/>		4299030	Water Pump	1	
<input type="checkbox"/>	5	3008468	Pipe Plug	1	1/2 NPT.
<input type="checkbox"/>	6	3008469	Pipe Plug	1	3/4 NPT.
<input type="checkbox"/>	7	3008470	Pipe Plug	1	1 NPT.
<input type="checkbox"/>		3037536	Threaded Plug	2	9/16 - 18 UNF.
<input type="checkbox"/>	8	3037537	O-Ring Seal	1	
	9	3040813	Threaded Plug	1	9/16 - 18 UNF.
<input type="checkbox"/>	8	3037537	O-Ring Seal	1	
		4299029	Water Pump	1	
<input type="checkbox"/>	10	S 16002	Ball Bearing	1	
<input type="checkbox"/>	11	160586	Retaining Ring	1	
<input type="checkbox"/>	12	3019600	Oil Seal	1	
<input type="checkbox"/>	13	3035679	Water Pump Impeller	1	
<input type="checkbox"/>	14	3038991	Water Pump Gear	1	
<input type="checkbox"/>	15	3064634	Retaining Ring	1	
<input type="checkbox"/>	16	3073695	Water Pump Cover	1	
<input type="checkbox"/>	17	3335044	Hexagon Head Cap Screw	3	M10 X 1.50 X 25.

<input type="checkbox"/>	18	3400813	Water Pump Shaft	1	
<input type="checkbox"/>	19	3820791	O-Ring Seal	1	
<input type="checkbox"/>	20	4926553	Water Pump Body	1	
<input type="checkbox"/>	21	2878069	Water Pump Seal	1	
<input type="checkbox"/>	22	2863701	O-Ring Seal	1	
<input type="checkbox"/>	23	3900631	Hexagon Flange Head Cap Screw	2	M8 X 1.25 X 25.
<input type="checkbox"/>		2882145	Water Pump Kit	1	
<input type="checkbox"/>		2863701	O-Ring Seal	1	
<input type="checkbox"/>		3027924	Connection Gasket	1	
<input type="checkbox"/>		3335044	Hexagon Head Cap Screw	3	M10 X 1.50 X 25.
<input type="checkbox"/>		3820791	O-Ring Seal	1	
<input type="checkbox"/>		3892095	O-Ring Seal	2	
		4299041	Water Pump	1	
<input type="checkbox"/>		S 16002	Ball Bearing	1	
<input type="checkbox"/>		160586	Retaining Ring	1	
<input type="checkbox"/>		2878069	Water Pump Seal	1	
<input type="checkbox"/>		3019600	Oil Seal	1	
<input type="checkbox"/>		3035679	Water Pump Impeller	1	
<input type="checkbox"/>		3038991	Water Pump Gear	1	
<input type="checkbox"/>		3064634	Retaining Ring	1	
<input type="checkbox"/>		3400813	Water Pump Shaft	1	
<input type="checkbox"/>		4926553	Water Pump Body	1	
<input type="checkbox"/>		2882146	Water Pump Repair Kit		Minor
<input type="checkbox"/>		S 16002	Ball Bearing	1	
<input type="checkbox"/>		160586	Retaining Ring	1	
<input type="checkbox"/>		2863701	O-Ring Seal	1	
<input type="checkbox"/>		2878069	Water Pump Seal	1	

<input type="checkbox"/>		3019600	Oil Seal	1	
<input type="checkbox"/>		3035679	Water Pump Impeller	1	
<input type="checkbox"/>		3064634	Retaining Ring	1	
<input type="checkbox"/>		3820791	O-Ring Seal	1	

© 2019 Cummins Inc., Box 3005, Columbus, IN 47202-3005 U.S.A.
Terms of Use and Disclaimers | Recommended System Requirements
Need Assistance? Please click on the Contact Us button in the top right corner of any page.